

**EXTREME OUTDOOR
SPORTS SCIENCE**

XOSS



NEBULA

Product Introduction

XOSS Nebula is an intelligent customizable bicycle accessory designed to improve cycling safety and user experience.

Its main features include customizable LED matrix display, bluetooth connection and navigation prompts, brake detection warning, synchronized strobe in team mode, and low battery warning/notification.

Product List



XOSS Nebula x 1



Saddle rail mount x 1



Rubber pad x 1



Silicone strap x 1



Dedicated base x 1



Base rubber pad x 1



Rubber O-ring x 2



Type-C USB cable x 1



Hex wrench x 1



User manual x 1

Device Installation

■ Seatpost Mount

- ① Place the rubber pad on the seatpost
- ② Secure with silicone strap
- ③ Clip XOSS Nebula into the base and rotate 90 degrees

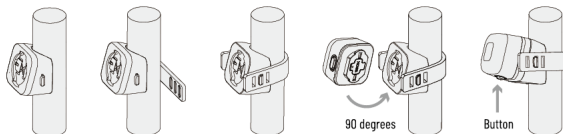

■ Other

- ① Clip base rubber pad into the back of dedicated base
- ② Secure it on helmet, backpack and so on
- ③ Clip XOSS Nebula into the base and rotate 90 degrees

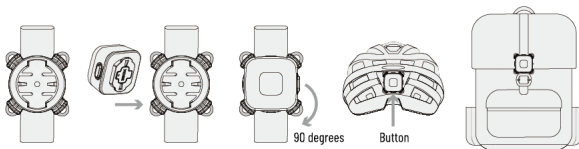

■ Saddle Rail Mount

- ① Clip the saddle rail mount onto the saddle rail and use hex wrench to secure the screws
- ② Adjust the angle of the base and lock the screws
- ③ Clip XOSS Nebula into the base and rotate 90 degrees

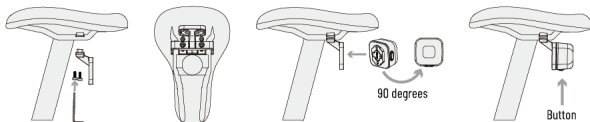

Instructions For Use

- ① Long press to turn on, click to cycle through flashing modes/patterns after powering on.
- ② Long press to turn off and click to display the remaining battery after turning off the power.
- ③ Taillight is high when braking.
- ④ Enter sleep mode after a long time stationary.

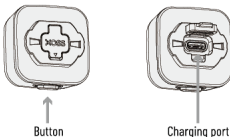

*Make sure the product has enough power before riding.

XOSS APP Support

Search XOSS in Google play store/APP store, or scan QR CODE on the right to download and install the XOSS APP.
Click Devices > Sensors to search and connect.



XOSS APP



QR CODE

*Compatible with smartphone systems of iOS 13.0, Android 7.0, or later

■ Customized Pattern

Customizable pattern, brightness and color of the pattern via the XOSS APP.

■ Synchronized Strobe Pattern

Automatically detect and synchronize taillights with the same team pattern.
Automatically switches to individual mode when out of group distance.

■ Automatic Signal Light

Connect with the mobile phone APP/bike computer to automatically turn on during workout, providing a more convenient use experience without the need to manually turn on the taillights.
It can also receive navigation information from the APP/bike computer and provide left and right turning signals according to the route.

For more features, you can upgrade the firmware of your device in the APP.

Product Specification

Endurance Time: 8 to 35 hours (different flash modes)

Charging Methods: TYPE-C, PD charger

Battery Capacity: 500mAh

Charging input: 5V== 300mA

Waterproof: IPX7, able to handle different weather conditions

Operating temperature: -10 ℃ to 60 ℃

Storage temperature: -20 ℃ to 70 ℃

Mounting options: seatpost, helmet, backpack and saddle rail

After-sales Service & Warranty

It has a one-year free warranty from the date of purchase, please contact your original dealer for warranty service.

The following conditions are not covered by the warranty:

1. The normal aging loss of the battery;
2. Damage and loss of products due to improper installation;
3. Damage caused by abnormal use, such as high temperature and water damage;
4. Damage caused by dismantling yourself or by unauthorized maintenance personnel.

Support

Please access <https://www.xoss.co> or help.xoss.co for more product information.

XOSS
EXTREME OUTDOOR SPORTS SCIENCE